

THE PARKS

RED HILL

TRAFFIC LIGHT – NOTICE OF FORECAST WORKS – Fortnightly Forecast

Weeks 02nd Mar'20 – 07th Mar'20

KEY

- Low Impact Work
- Med -Level Work
- High Impact Work

WC 02/03/20	Location	Description of works	Rating
Monday 02/3 –Tuesday 03/3	MONARO CRESCENT/CYGNET CRESCENT (Lot 1)	<u>Subsoil drains</u> Trench excavations for new services Noise – Medium Dust – Medium Vibrations – Low	●
	LA PEROUSE STREET/DISCOVERY STREET (Lot 8)	<u>Earthworks and ACM Remediation Works</u> ACM Abatement and Level 1 Fill – Heavy plant movement (Excavators, Tipper, Roller, Dozer and Watercarts) Noise – High Dust – Medium Vibrations – High	●
	WALTERHOOD LANE/CYGNET CRESCENT (Lot 4) Opposite Beagle Street	<u>Earthwork Activities</u> Trenches – Heavy plant movement (Excavators and watercarts) Noise -high Dust - medium Vibrations – medium	●
	DISCOVERY STREET (Section between Monaro Crescent and The Parks display village closed)	<u>Hydraulics</u> Trench excavations for new services Noise – Medium Dust – Low Vibrations – Low	●
	ENDEAVOUR STREET/ MONARO CRESCENT (Lot 2)	<u>ACM Remediation Works</u> Noise – High Dust – High Vibrations – Medium	●
	LA PEROUSE STREET/CYGNET CRESCENT STREET (Lot 7)	<u>Earthworks and ACM Remediation Works</u> Level 1 Fill – Heavy plant movement (Excavators, Tipper, Roller, Dozer and Watercarts) Noise – High Dust – Medium Vibrations – Medium	●

How to contact us

Subscribe for updates at

<https://www.theparksredhillcommunity.com.au>



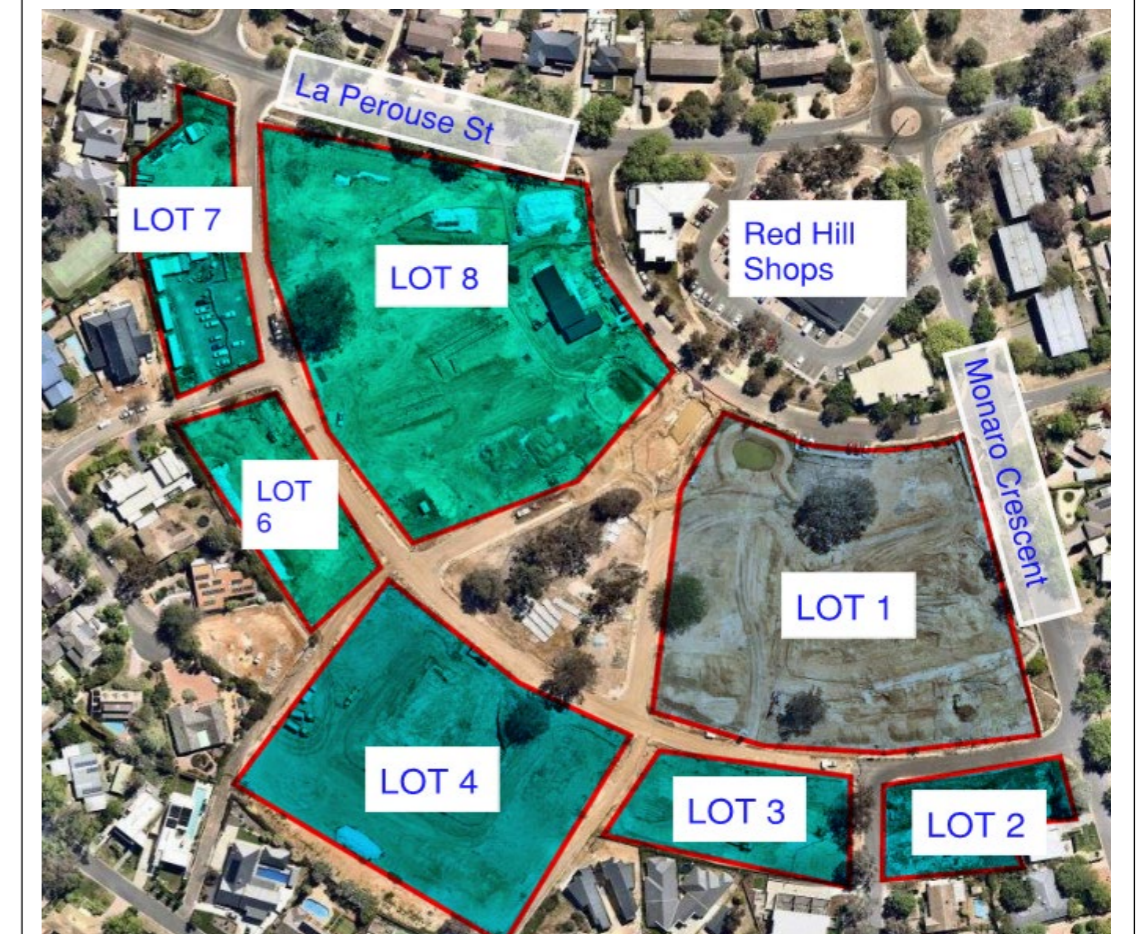

Toll free call 1800 909 773

Email: info@theparksredhillcommunity.com.au

Low Impact Work	Medium – Level Work	High Impact Work
<ul style="list-style-type: none"> •Low levels of Dust (Managed) •Low Level Noise •No Vibration 	<ul style="list-style-type: none"> •Low Levels of Dust (Managed) •Low Level Noise •Low level Vibration 	<ul style="list-style-type: none"> •High levels of Dust •Noticeable Noise Levels •Noticeable Vibration



WEEK COMMENCING – 02nd / Mar 2020

<u>WC</u> <u>02/03/20</u>	<u>Location</u>	<u>Description of works</u>	<u>Rating</u>
Wednesday 04/3 – Saturday 07/3	MONARO CRESCENT (Road Closed)	<u>Hydraulics</u> Trench excavations across Monaro Cr for new services Noise – High Dust – Medium Vibrations – Medium	
	LA PEROUSE STREET/DISCOVERY STREET (Lot 8)	<u>Earthworks and ACM Remediation Works</u> ACM Abatement and Level 1 Fill – Heavy plant movement (Excavators, Tipper, Roller, Dozer and Watercarts) Noise – High Dust – Medium Vibrations – High	
	WALTERHOOD LANE/CYGNET CRESCENT (Lot 4) Opposite Beagle Street	<u>Earthwork Activities</u> Trenches – Heavy plant movement (Excavators and watercarts) Noise -High Dust - Low Vibrations – Medium	
	ENDEAVOUR STREET/ MONARO CRESCENT (Lot 2)	<u>ACM Remediation Works</u> Noise – High Dust – High Vibrations – Medium	
	DISCOVERY STREET (Section between Monaro Crescent and The Parks display village closed)	<u>Hydraulics</u> Trench excavations for new services Noise – Medium Dust – Low Vibrations – Low	

WEEK COMMENCING – 02nd / Mar 2020