

# THE PARKS

RED HILL

## TRAFFIC LIGHT – NOTICE OF FORECAST WORKS – Fortnightly Forecast

Week 16<sup>th</sup> Mar'20 – 21<sup>st</sup> Mar'20

### KEY

- Low Impact Work
- Med -Level Work
- High Impact Work

### How to contact us

Subscribe for updates at

<https://www.theparksredhillcommunity.com.au>



Toll free call 1800 909 773

Email: [info@theparksredhillcommunity.com.au](mailto:info@theparksredhillcommunity.com.au)

WC 16/03/20	Location	Description of works	Rating
	MONARO CRESCENT /DISCOVERY STREET (Lot 1)	<u>Earthworks</u> Road and lane ways – subbase (Heavy plant movement) Noise – Medium Dust – Medium Vibrations – Low	●
	LA PEROUSE STREET/DISCOVERY STREET (Lot 8)	<u>Earthworks and ACM Remediation Works</u> ACM Abatement and Level 1 Fill – Heavy plant movement (Excavators, Tipper, Roller, Dozer and Watercarts) Noise – High Dust – High Vibrations – Medium	●
	WALTERHOOD LANE/CYGNET CRESCENT (Lot 4) Opposite Beagle Street	<u>Earthwork Activities</u> Level 1 Fill – Heavy plant movement (Excavators and watercarts) Noise - medium Dust - Low Vibrations – medium	●
	DISCOVERY STREET (Section between Monaro Crescent and The Parks display village closed)	<u>Hydraulics</u> Trench excavations for new services Noise – Medium Dust – Low Vibrations – Low	●
	ENDEAVOUR STREET/ MONARO CRESCENT (Lot 2)	<u>ACM Remediation Works</u> Noise – Low Dust – Medium Vibrations – Low	●
	LA PEROUSE STREET/CYGNET CRESCENT STREET (Lot 7 – South Section)	<u>Earthworks and ACM Remediation Works</u> Level 1 Fill – Heavy plant movement (Excavators, Tipper, Roller, Dozer and Watercarts) Noise – High Dust – Low Vibrations – Medium	●

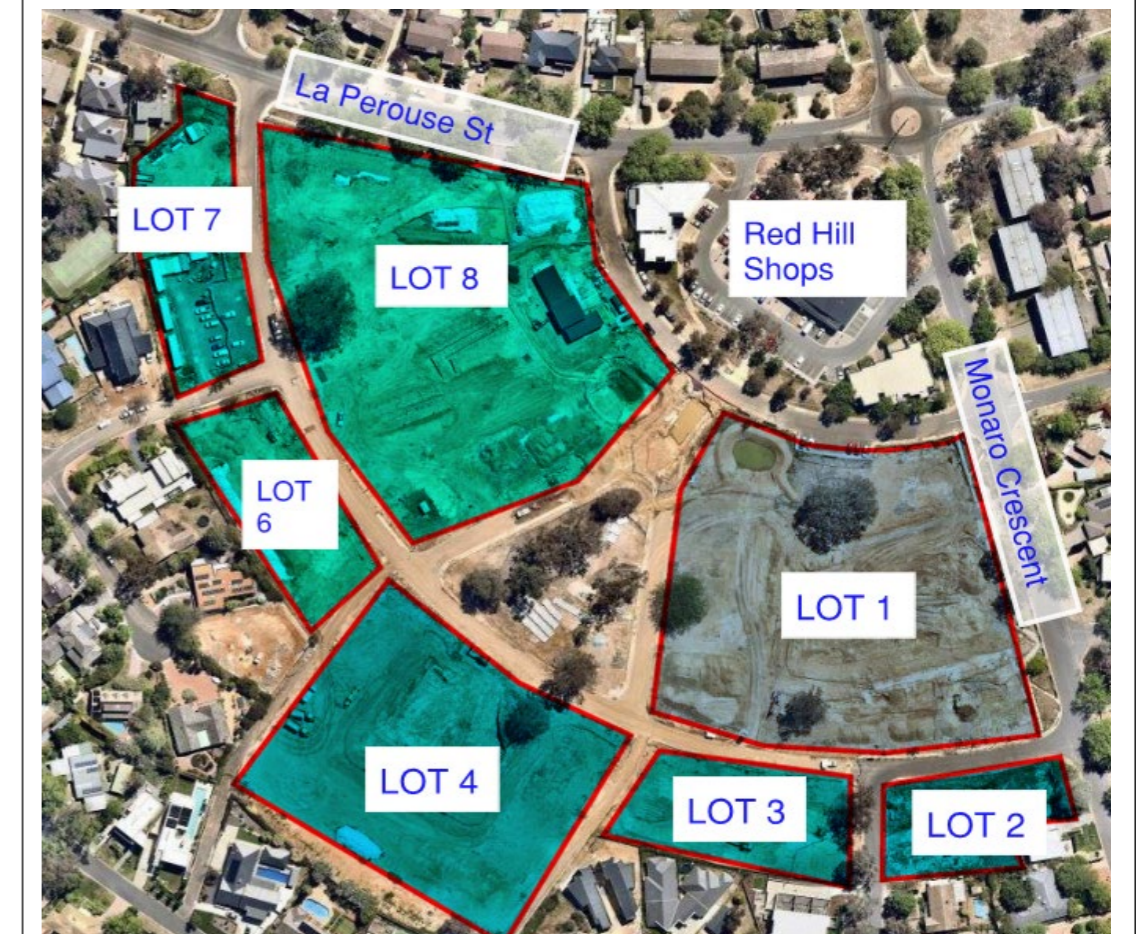
Low Impact Work	Medium – Level Work	High Impact Work
<ul style="list-style-type: none"> <li>•Low levels of Dust (Managed)</li> <li>•Low Level Noise</li> <li>•No Vibration</li> </ul>	<ul style="list-style-type: none"> <li>•Low Levels of Dust (Managed)</li> <li>•Low Level Noise</li> <li>•Low level Vibration</li> </ul>	<ul style="list-style-type: none"> <li>•High levels of Dust</li> <li>•Noticeable Noise Levels</li> <li>•Noticeable Vibration</li> </ul>



	MONARO CRESCENT (Road Closed)	<u>Hydraulics</u> Trench excavations across Monaro Cr for new services Noise – High Dust – Medium Vibrations – Medium	
	LA PEROUSE STREET/CYGNET CRESCENT STREET (Lot 7 – North Section)	<u>Site office Relocation</u> Noise – Medium Dust – Low Vibrations – Low	
Saturday 21/3	LA PEROUSE STREET/CYGNET CRESCENT STREET (Lot 7 – South Section)	<u>ACM Remediation Works</u> Noise – Medium Dust – Medium Vibrations – Medium	
<b>MONARO CRESCENT (ROAD CLOSURE)</b>			
<p>Due to recent inclement weather condition the planned road closure for the installation of hydraulic services was not implemented as previously advised. The closure had been planned for implementation from the 04<sup>th</sup> of March 2020, but this will now be updated after advice has been received from Icon Water.</p> <p>A new date will be communicated to all residents and community stakeholders once it has been confirmed with the respective authorities including Icon Water and TCCS.</p>			

WEEK COMMENCING – 16<sup>th</sup> / Mar 2020